

102 Hersham Road, Walton on Thames, Surrey, KT12 5NU



£239,950 Leasehold

Conveniently positioned on the Hersham Road in the charming town of Walton on Thames, this delightful one-bedroom conversion apartment offers a perfect blend of comfort and convenience. Situated on the first floor, the property is just a short stroll from Walton mainline station, making it an ideal choice for commuters. Local shops and schools are also within easy reach, enhancing the appeal for both individuals and small families.

Upon entering, you will find a modern kitchen that features an inviting archway leading into the spacious living/dining area. This open-plan layout creates a warm and welcoming atmosphere, perfect for both relaxation and entertaining. The apartment boasts one well-proportioned bedroom, providing a peaceful retreat at the end of the day, along with a contemporary bathroom that meets all your needs.

Additionally, the property benefits from parking available to the front, a valuable asset in this sought-after location. With no onward chain, this apartment is ready for you to move in and make it your own. Whether you are a first-time buyer or looking to downsize, this flat presents an excellent opportunity to enjoy a comfortable lifestyle in a vibrant community. Do not miss the chance to view this lovely home.

INDEPENDENT ESTATE AGENTS

www.htbproperty.com

SALES • LETTINGS • MANAGEMENT

Walton Branch
45A High Street
Walton on Thames
Surrey KT12 1DH
01932 222266

sales@htbproperty.com
lettings@htbproperty.com



Registered address: 2 AC Court, Hight Street, Thames Ditton KT7 0SR Registered in England, Number 6433673

Molesey Branch
45 Walton Road
East Molesey
Surrey KT8 0DP
0208 001 8385

INDEPENDENT ESTATE AGENTS

www.htbproperty.com

SALES • LETTINGS • MANAGEMENT

Walton Branch
45A High Street
Walton on Thames
Surrey KT12 1DH
01932 222266

sales@htbproperty.com
lettings@htbproperty.com



Registered address: 2 AC Court, Hight Street, Thames Ditton KT7 0SR Registered in England, Number 6433673

Molesey Branch
45 Walton Road
East Molesey
Surrey KT8 0DP
0208 001 8385

102 Hersham Road, Walton on Thames, Surrey, KT12 5NU

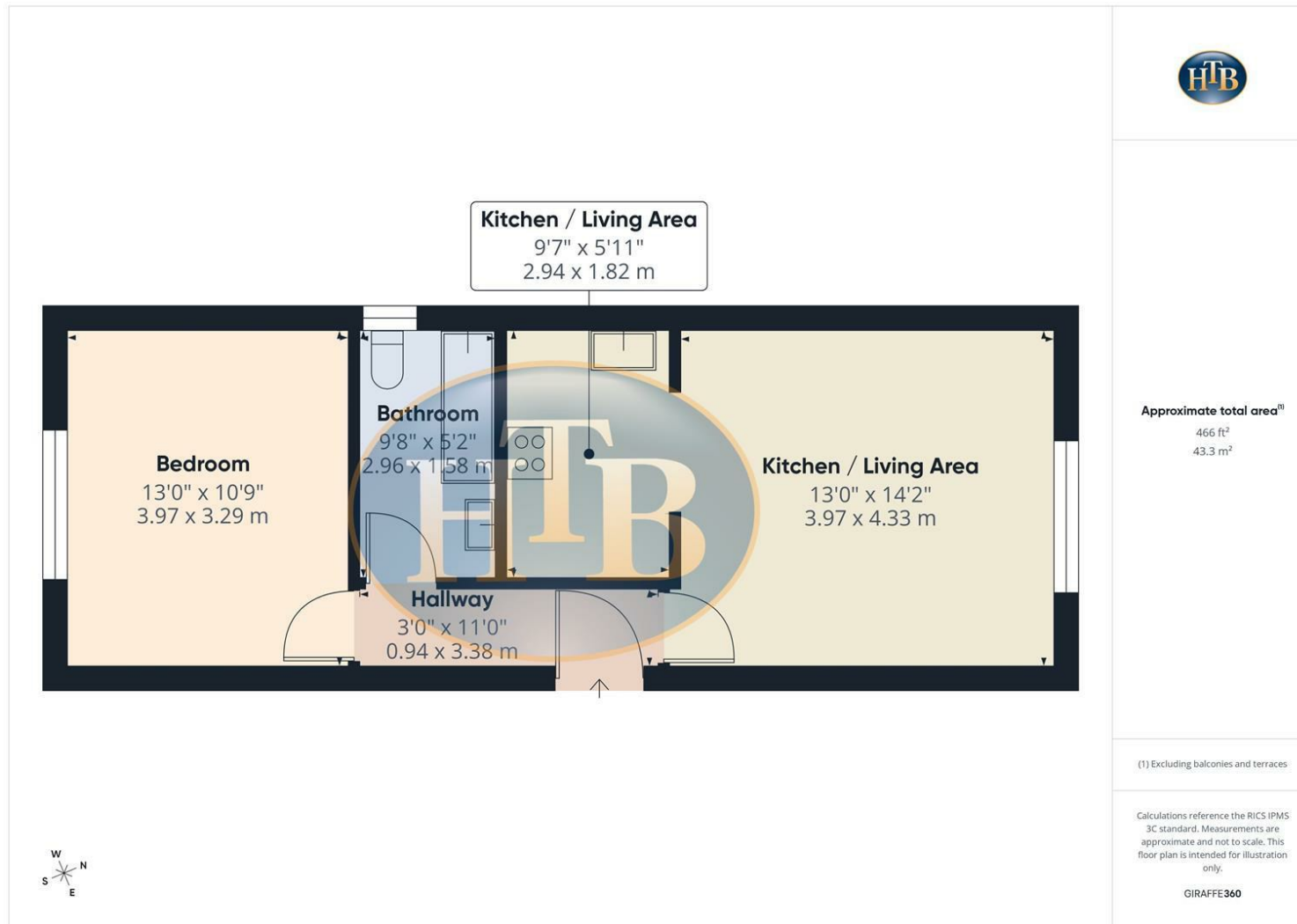

- OFF STREET PARKING TO FRONT
- FIRST FLOOR
- NO ONWARD CHAIN
- ONE DOUBLE BEDROOM
- CLOSE TO LOCAL SHOPS AND RESTAURANTS
- COUNCIL TAX BAND C
- SHORT WALK TO MAINLINE STATION
- EXCEPTIONAL VALUE